

## FEATURES

- All steel outer
- Resin retainer
- Sealed both ends
- Standard ball bushing dimensions
- Available as open or closed series
  
- Also available: *Stainless steel version*

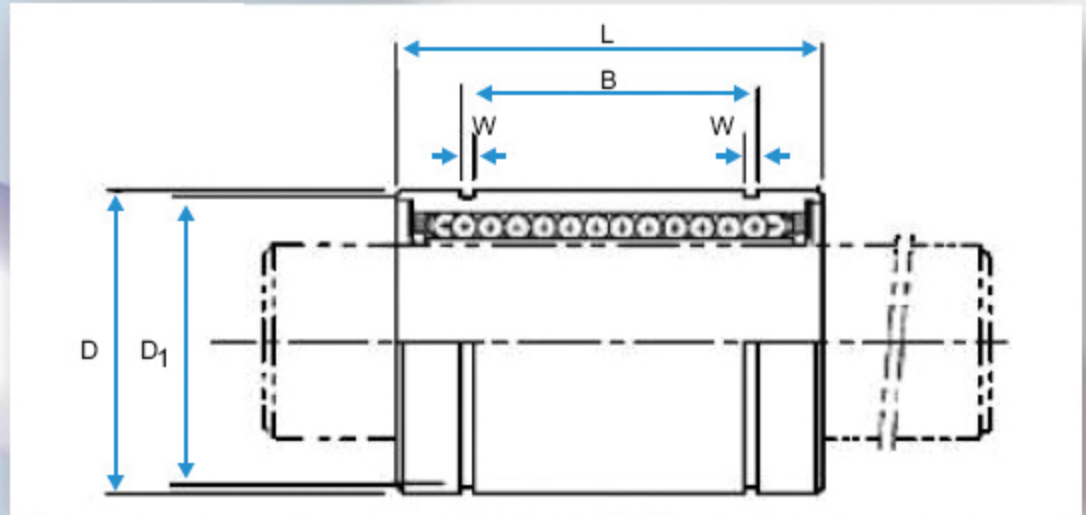
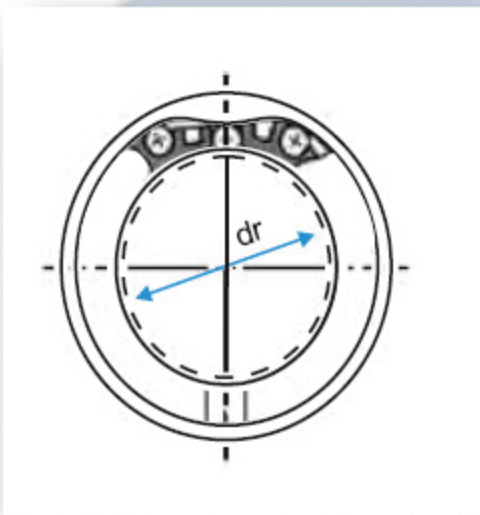
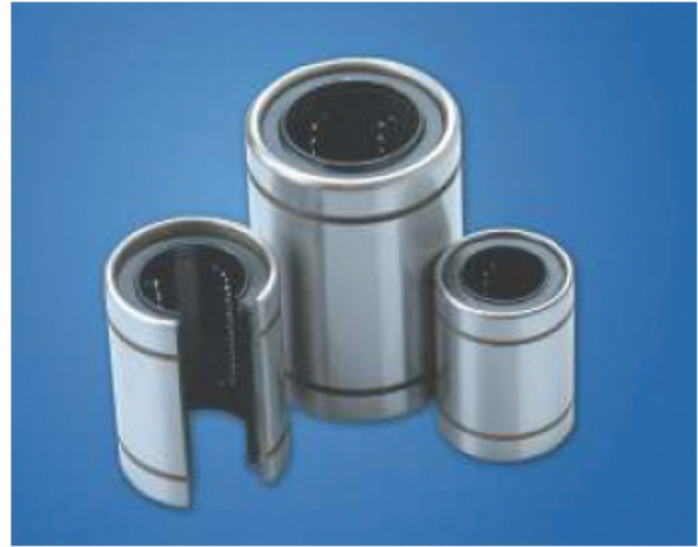

Dimensions: (mm)

Part number	dr	No. of ball circuits	Tolerance						Basic load rating		Unit weight g	
	∅		D	L	tol	B	tol	W	D1	C N		C <sub>0</sub> N
KB5GUU	5	4	12	22	0 -0.12	14.5	0 -0.2	1.1	11.5	206	265	11
KB8GUU	8	4	16	25	0 -0.2	16.5	0 -0.2	1.1	15.2	265	402	22
KB12GUU	12	4	22	32	0 -0.2	22.9	0 -0.2	1.3	21	510	784	45
KB16GUU	16	4	26	36	0 -0.2	24.9	0 -0.2	1.3	24.9	578	892	60
KB20GUU	20	5	32	45	0 -0.2	31.5	0 -0.2	1.6	30.3	862	1,370	102
KB25GUU	25	6	40	58	0 -0.2	44.1	0 -0.3	1.85	37.5	980	1,570	235
KB30GUU	30	6	47	68	0 -0.3	52.1	0 -0.3	1.85	44.5	1,570	2,740	360
KB40GUU	40	6	62	80	0 -0.3	60.6	0 -0.3	2.15	59	2,160	4,020	770
KB60GUU	60	6	90	125	0 -0.4	101.7	0 -0.4	3.15	86.5	4,700	9,800	2,220
*KB80UU	80	6	120	165	0 -0.4	133.7	0 -0.4	4.15	116	7,350	16,000	5,140

\*KB80UU has a steel retainer

1N=0.102kgf



**STATEWIDE**  
**LINEAR BEARINGS**