

FEATURES

- Tandem version (2 bearings per housing)
- Aluminium alloy housing
- Super ball bushings
- Sealed

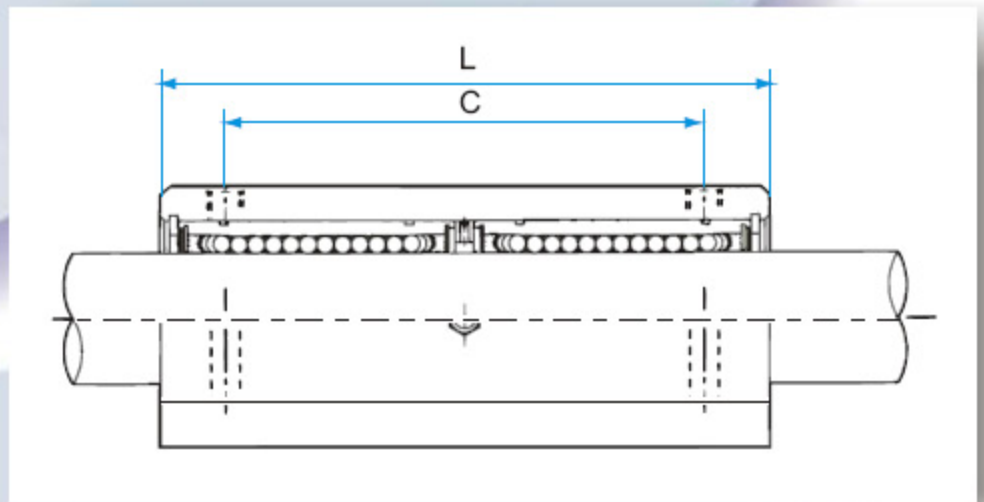

• Also available with, stainless steel or ceramic bearings

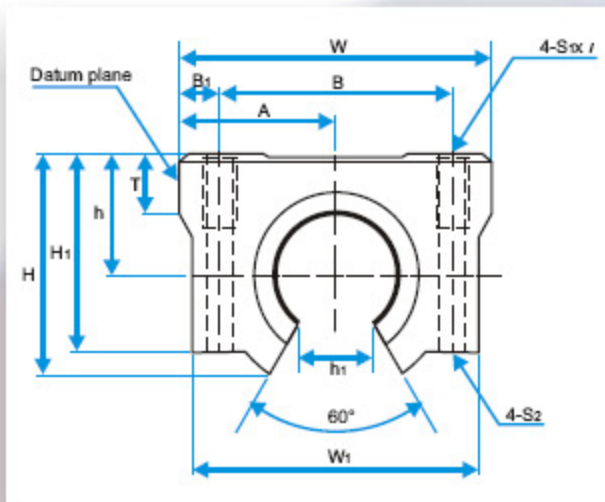

SEE PAGE 18 FOR MATCHING SUPPORT RAILS

Dimensions: (mm)

Part number	Shaft size ∅	Height H	Width W	Length L	Mounting hole position			h1	TAP		±0.02 h	±0.05 A	H1	W1	T	Basic load rating		Unit weight g
					B	B1	C		S1X1	S2						C N	Co N	
SC 12TKW OPN	12	28	44	77	33	5.5	64	7	M5x10	M4	15	22	26	41	8	1652	2580	180
SC 16TKW OPN	16	35	50	89	36	7	79	9	M5x12	M4	19	25	35	46	9	2025	3100	280
SC 20TKW OPN	20	39	54	106	40	7	90	9	M6x12	M5	21	27	36	52	11	3390	5260	410
SC 25TKW OPN	25	47	76	136	54	11	119	12	M8x18	M6	26	38	41	68	12	6120	9440	850
SC 30TKW OPN	30	55	78	154	58	10	132	14	M8x18	M6	30	39	49	72	15	8860	13620	1170
SC 40TKW OPN	40	74	102	180	80	11	150	20	M10x25	M8	40	51	62	96	20	10680	16460	2450
SC 50TKW OPN	50	98	122	230	100	11	200	23	M8x18	M8	52	61	80	116	25	18000	12940	4770

1N=0.102kgf



STATEWIDE
LINEAR BEARINGS